



# SURE-FAST

INDUSTRIAL FASTENERS

# Product Data Sheet

## TIE WIRE ANCHOR

- Quick and easy carbon steel anchor installed by pulling back with a claw hammer.
- Suitable for lightweight anchoring in concrete.
- Material: Carbon Steel – Zinc Yellow finish.

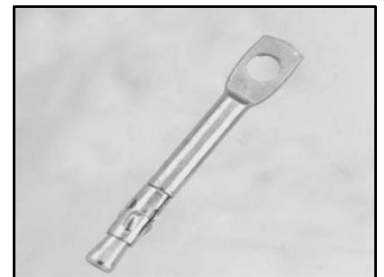

PRODUCT CODE	ANCHOR SIZE	DRILL DIAMETER	EYE SIZE	MIN EMBEDHENT	PULL OUT LOAD (KN) <sub>1</sub>
53040065	M6 x 60L	6.0	6.3	35	4.707

<sup>1</sup> A safe working load should not exceed 25% of stated values.

### INSTALLATION

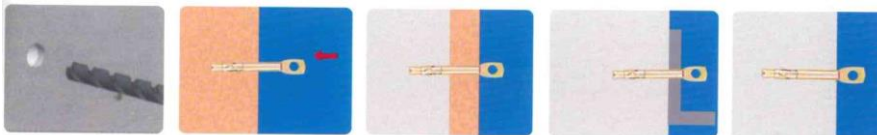

**Disclaimer:** Every reasonable effort has been made to ensure that this document is correct at the time of printing. Sure-Fast Industrial Fasteners makes no warranty, expressed or implied, regarding the accuracy of the data or the results to be obtained from the use thereof. The information is supplied solely for your information and consideration and it is the responsibility of the user to comply with all applicable federal, state and local laws and regulations.

[www.sure-fast.com.au](http://www.sure-fast.com.au)